

**ALTA COMMITMENT FOR TITLE
INSURANCE EXHIBIT "A"
LEGAL DESCRIPTION**

ISSUED BY
Stevens County Title & Escrow

File No.: 25-42857-SCT

Parcel 5609015:
The S1/2 of the SW1/4 of the NE1/4 of Section 30, Township 33 North, Range 41 East, W.M., in
Stevens County, Washington.

Abbreviated Legal: P/O NE1/4, 30-33-41

Tax Parcel No.: 5609015

Property Address: 2686 TBD Burnt Valley Road, Chewelah, WA 99109

Seller: _____

Buyer: _____

Seller: _____

Buyer: _____

The address shown above is provided for information only, as a convenience for the customer and is not included in the legal description to be insured. The Address was determined by public records and the Company assumes no liability for any inaccuracy of the address.

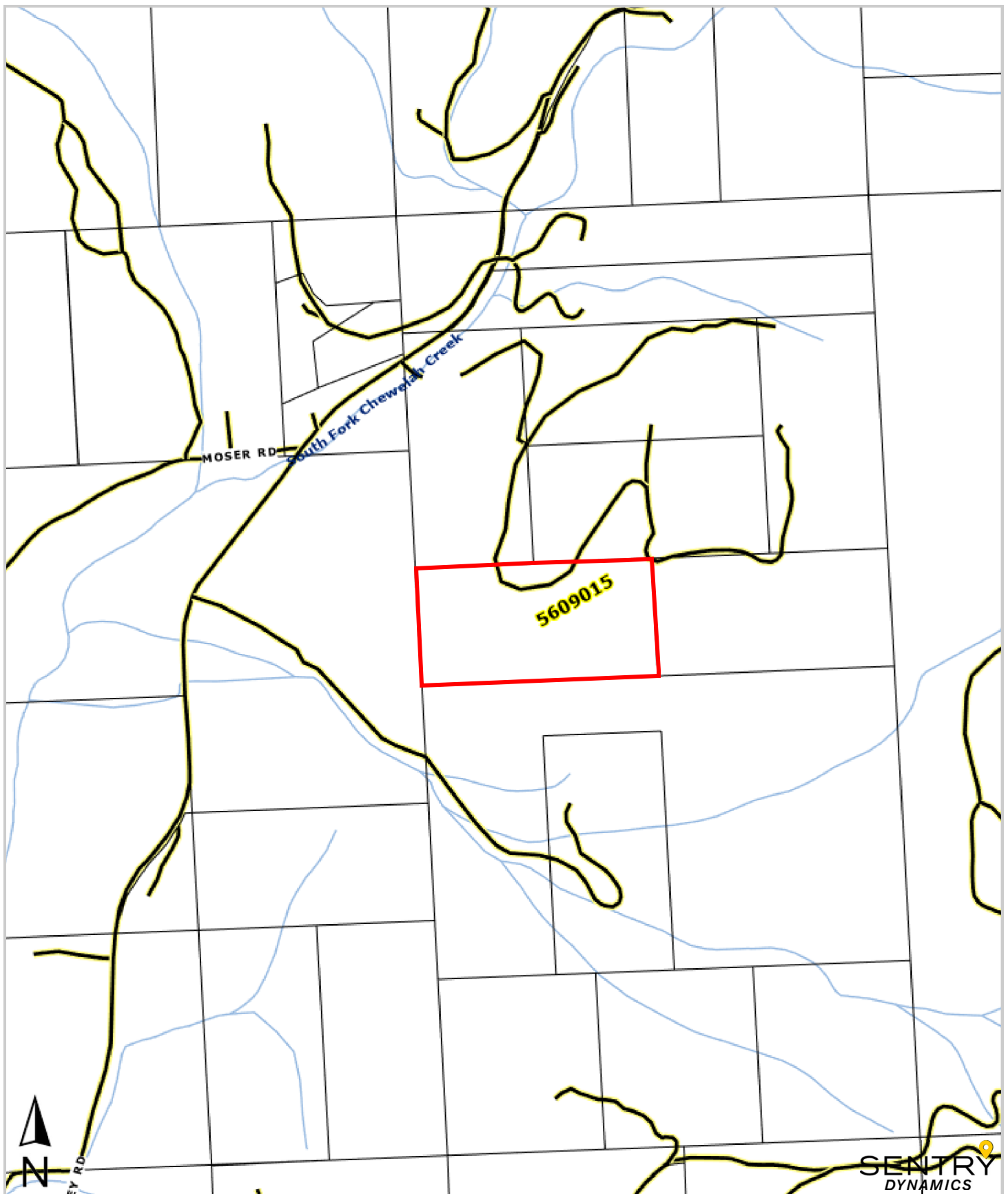

STEVENS COUNTY
TITLE & ESCROW

This map/plat is being furnished as an aid in locating the herein described land in relation to adjoining streets, natural boundaries and other land, and is not a survey of the land depicted. Except to the extent a policy of title insurance is expressly modified by endorsement, if any, the company does not insure dimensions, distances, location of easements, acreage or other matters shown thereon.