

**NORTHEAST TRI COUNTY HEALTH DISTRICT
DIVISION OF ENVIRONMENTAL HEALTH**

ON-SITE SEWAGE SYSTEM PERMIT # PT0017249

Robert & Diane Keudell is hereby authorized to utilize a sewage disposal system at
S of Rd #2852 NW4 NW4, Ls S 380'

Section: 23 Township: 138 Range: 37 Parcel #: 1734450

In accordance with the plans and specifications approved by the District Health Officer on file in this office.

Prior to any major repairs, replacements or alterations to the system a permit shall be obtained from the NorthEast Tri County Health District (Division of Environmental Health).

This permit is issued and may be revoked by the NorthEast Tri County Health District Health Officer by authority of WAC 246-272, and Northeast Tri County Health District Regulations established by the Board of Health pursuant to RCW 70.05.

Additional permits from other jurisdictions or agencies may be necessary for this project. It is the responsibility of the applicant to acquire said permit(s), and comply with all applicable rules, regulations and/or ordinances.

Date Issued: 10/21/2014



District Health Officer

PERMIT INSTRUCTIONS

STRUCTURE TYPE: Single-Family Residential

NUMBER OF BEDROOMS: 3

DESIGN FLOW (gal/day): 360

TYPE OF SYSTEM: Expansion

SYSTEM DESIGN: Gravity w/ Gravelless Chambers

SEPTIC TANK CAPACITY (gal): 1000

DFLF/BED DIMENSIONS: 256

TRENCH DEPTH (inches): 36

TENCH WIDTH (inches): 36

APPURTANENCES: Distribution Box

PUMP CHAMBER (y/n):

PUMP CHAMBER GALLONS:

REASON SYSTEM DESIGN:

SPECIAL PERMIT INSTRUCTIONS: 15% reduction from 300' for use of gravelless chambers

FINAL INSPECTION DATE: 12/12/14

Initials: DE

**** SEE REVERSE FOR AS BUILT DRAWING**

Stevens County Office	240 E Dominion	Colville,	WA	99114	(509) 684-2262
Pend Oreille County Office	605 Hwy 20	Newport,	WA	99156	(509) 447-3131
Ferry County Office	P.O. Box 584	Republic,	WA	99166	(509) 775-3111



On-Site Sewage System As-Built Drawing for Permit # PT0017249

Inspection Date	11/13/14	Approved <input checked="" type="checkbox"/> Yes <input type="checkbox"/> No	Approved Date	11/13/14
Inspection By	DE		Re-Inspection Date	

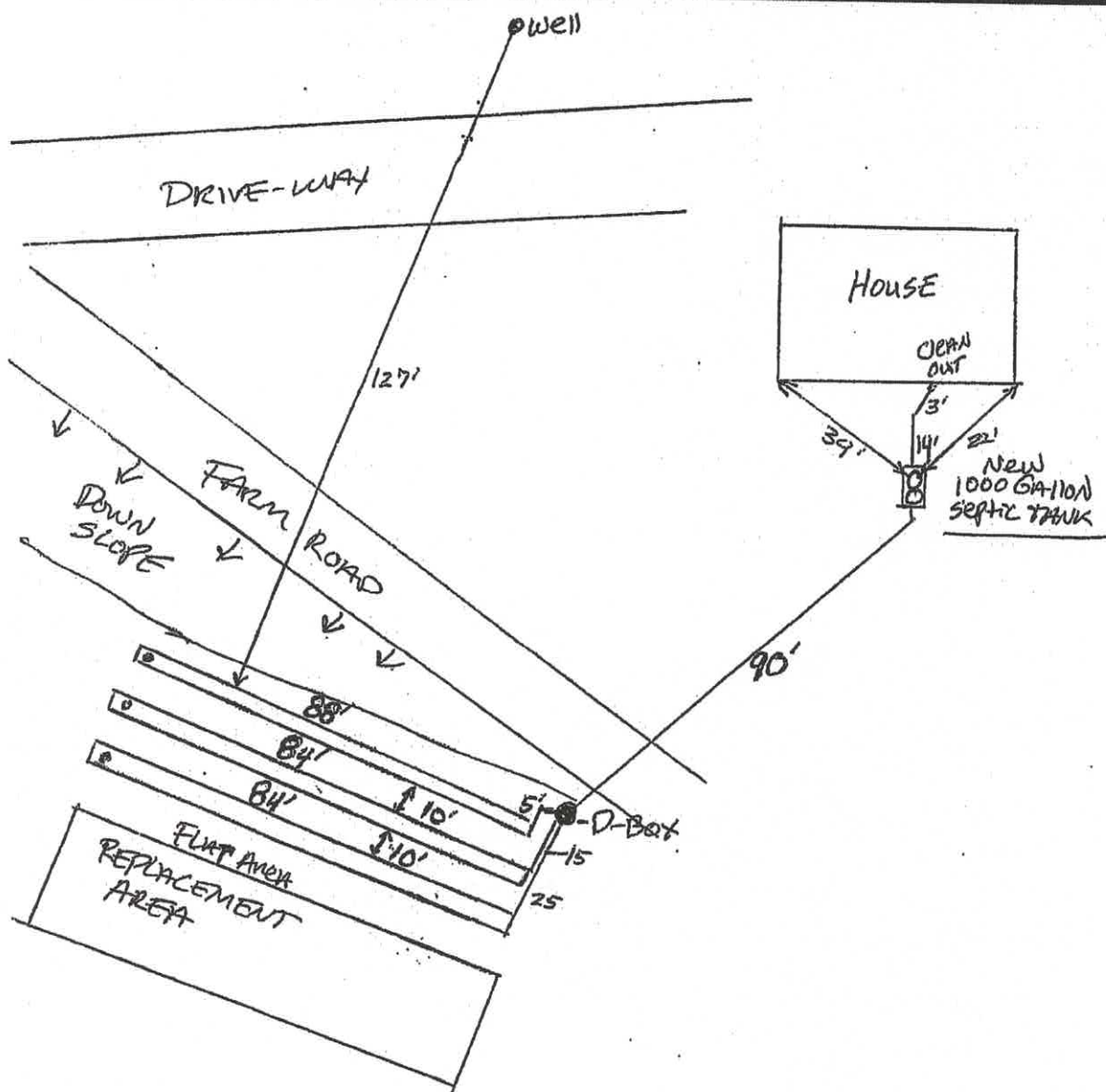

Installer Name	DICK STEWART		Pump Chamber Size	
Septic Tank Size	1000 GALLONS	Dose/day		Gallons/Dose
Drainfield Length	256'	Squirt Height		Drawdown
Drainfield Depth	36"	Pump Run Time		
Septic Tank Latitude/Longitude	48° 46' 57.1346 / 118° 04' 52.4828			